

DD28

Single Phase Electromechanical Energy Meter



Application

Model DD28 single phase electromechanical front board installed active energy meter is a kind of new style single phase two wire active energy meter, fully absorb new technologies about electromechanical meter from domestic and abroad. The meter completely accord with relevant technical requirements of class 2 single phase active energy meter stipulated in International standard IEC 62053-11. It can accurately and directly measure 50Hz or 60Hz active energy consumption from single phase AC electricity net, it is use for setting indoor or out door meter box. The meter has novel design, rational structure, and it can display total energy consumption by drum wheel mechanical counter. It has following features: Compact structure design, small size, economy benefits, specious appearance, etc.

Functions and features

- Front board two holes fixed installation, the cover is made of high definition transparent glass material molded overall, the base of the meter is made of quality steel which is after double-through antirust processing, and the terminal block is made of quality bakelite material which is moisture-resistant, fire-retardant, high temperature molded overall. It has following features: Good weatherability, high rigid, specious appearance, etc.
- The meter frame adopt aluminum alloy molding with excellent mechanical strength, stable structure and anti-impact.
- Voltage components and current components are used of double insulation structure, have good electrical characteristics.
- Standard configuration voltage circuits and current circuits connection in meter case, may select connection outside. (please specified when ording)
- Standard configuration bottom bearing is used of double jewel bearing, upper oriented bearing is made of high wear resistance copper alloy bush and stainless steel needle. It has following features: long life and minimal friction, etc. May select magnetic thrust bearing or single jewel bearing .
- All kinds of error adjustment mechanisms have fine adjustment mechanisms to be adjusted which is finished by anti-creeping hole of disc and convenient for adjusting by users.
- Standard configuration 5 digits display by drum wheel mechanical counter, may select 6 digits display by drum wheel mechanical counter .
- Standard configuration without anti-reverse device, may select add anti-reverse function. (Please specified when ordering).
- Single component measure single phase two wire active energy consumption. Complying with standard IEC 62053-11.
- Direct connect operation, there are two types you may select. Standard configuration type B wiring, may select type A wiring .
- Extension terminal cover, it is for protecting use electrical safety.

Technical parameters

Model	Accuracy	Reference voltage (V)	Current specifications (A)	Starting current (A)	Insulation performance
DD28	Class 2	127 230	10(20)	0.05	AC voltage 2kV for 1 minute, 1.2/50us waveform impulse voltage 6kV
			20(40)	0.1	
			30(60)	0.15	
			40(80)	0.2	

*If you need different reference voltage or current specification, please advisory our sales

Outer and mount dimension

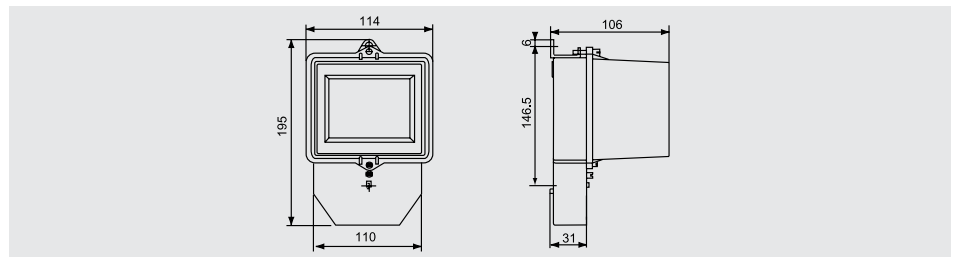

Wiring diagram

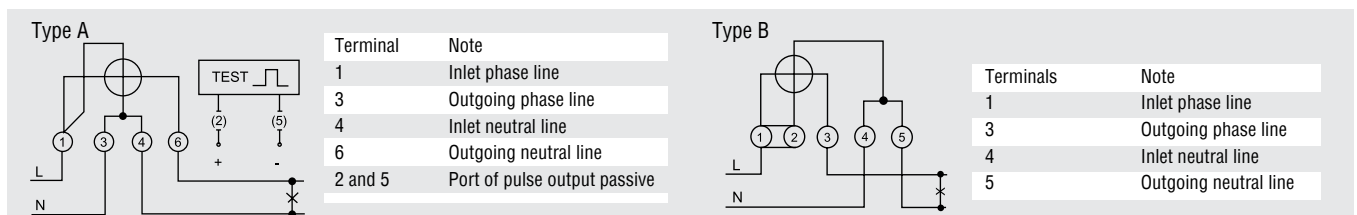

DD28

Single Phase Electromechanical Energy Meter



Application

Model DD28 single phase electromechanical front board installed active energy meter is a kind of new style single phase two wire active energy meter, it is designed on the basis of original DD284 single phase electromechanical meter, and fully absorb new technologies about electromechanical meter from domestic and abroad. The meter completely accord with relevant technical requirements of class 2 single phase active energy meter stipulated in International standard IEC 62053-11. It can accurately and directly measure 50Hz or 60Hz active energy consumption from single phase AC electricity net, it is use for setting indoor or out door meter box. The meter has novel design, rational structure, and it can display total energy consumption by drum wheel mechanical counter. It has following features: Compact structure design, small size, high overload, long-life, economy benefits, specious appearance, etc.

Functions and features

- Front board three holes fixed installation, the cover is made of high definition transparent glass material molded overall, the base of the meter is made of quality steel which is after double-through antirust processing, and the terminal block is made of quality bakelite material which is moisture-resistant, fire-retardant, high temperature molded overall. It has following features: good weatherability, high rigid, specious appearance, etc.
- The meter frame adopt aluminum alloy molding with excellent mechanical strength, stable structure and anti-impact.
- Voltage components and current components are used of double insulation structure, have good electrical characteristics.
- Standard configuration voltage circuit and current circuits connection meter case, may select connection outside. (Please specify when ording)
- Standard configuration adopt magnetic thrust bottom bearing, upperoriented bearing is made of high wear resistance copper alloy bush and stainless steel needle. It has following features: Long life and minimal friction, etc. May select doule gem bearing,
- All kinds of error a djustment mechanisms have fine adjustment mechanism. The meter starting and creeping needn to be adjusted which is finished by anti-creeping hole of disc and convenient for adjusting by users.
- Standard configuration 6 digits display by drum wheel mechanical counter, may select 5 digits display by drum wheel mechanical counter.
- Standard configuration without anti-reverse device, may select add anti-reverse function. (Please specified when ordering).
- Single component measure single phase two wire active energy consumption. Complying with standard IEC 62053-11.
- Direct connect operation, there are two types you may select. Standard configuration typeB wiring, may select type A wiring.
- Extension terminal cover, it is for protecting use electrical safety.

Technical parameters

Model	Accuracy	Rated voltage (V)	Rated current (A)	Starting current (A)	Insulation performance
DD28	Class 2	127 230	10(20)	0.05	AC voltage 2kV for 1 minute, 1.2/50us waveform impulse voltage 6kV
			20(40)	0.1	
			30(60)	0.15	
			40(80)	0.2	

*If you need different reference voltage or current specification, please advisory our sales

Outer and mount dimension

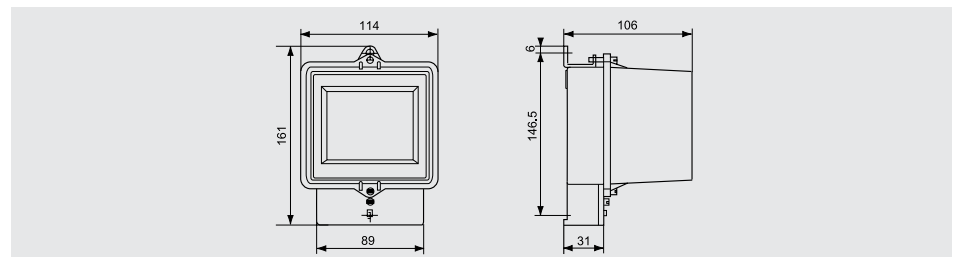

Wiring diagram

