

## CJ19 series Switch-over Capacitor Contactor

### 1. General

- 1.1 Electric ratings: AC50/60Hz, up to 380V;
- 1.2 Standard: IEC60947-4-1.

### 2. Type Designation

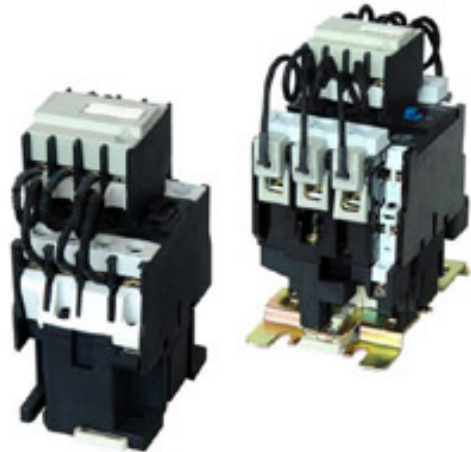
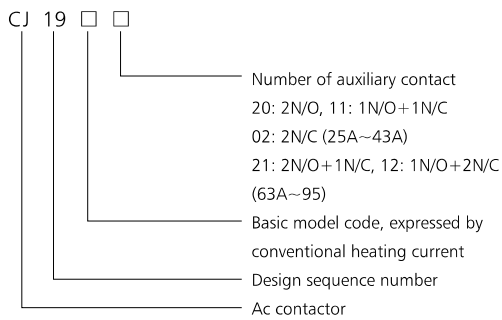

### 3. Normal Operation Conditions

- 3.1 Ambient temperature:  $-5^{\circ}\text{C} \sim +40^{\circ}\text{C}$ , the average during 24 hours should not exceed  $+35^{\circ}\text{C}$ .
- 3.2 Altitude:  $\leq 2000\text{m}$ ;
- 3.3 Atmosphere conditions: At mounting site, relative humidity not exceed 50% at the max temperature of  $+40^{\circ}\text{C}$ , higher relative humidity is allowable under lower temperature. For example, RH could be 90% at  $+20^{\circ}\text{C}$ , special measures should be taken to occurrence of dews.
- 3.4 Pollution degree: 3
- 3.5 Installation category: III
- 3.6 Installation conditions : the inclination between installation plane and vertical plane is within  $\pm 50^{\circ}$ .
- 3.7 Impact and shake: the products should locate in the places where there are no obvious impact and shake.

### 4. Technical Data

Model		CJ19-25	CJ19-32	CJ19-43	CJ19-63	CJ19-95
Electric life ( $\times 10^3$ )		100	100	100	100	100
Rated current $I_e$ (380V) A		17	23	29	43	63
Power of controlled capacitor	220/230V	6	9	10	15	22
	380/400V	12	18	20	30	40
Rated Insulation Voltage $U_i$ (V)		500				
Rated Operational Voltage $U_e$ (V)		380				
Restrained surge capacity		20 $I_e$				
Operation range		Pick-up: (85%~110%) $U_s$ ; drop-out: (20%~75%) $U_s$				
Coil power (VA)	Start-up	70	110	110	200	200
	Holding	8	11	11	20	20
Control capacity of auxiliary contact		AC-15 360VA; DC-13 33W				
Weight (kg)		0.44	0.63	0.64	1.4	1.5

## 5. Electric Diagram

CJ19-25~43

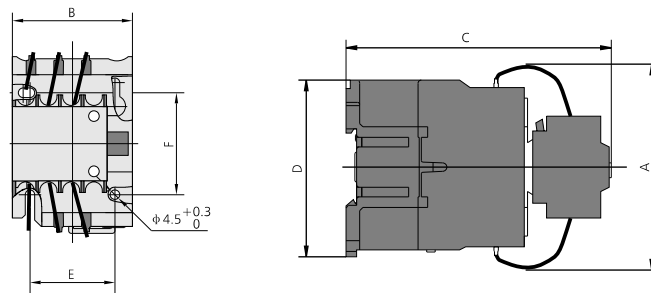

CJ19-63~95

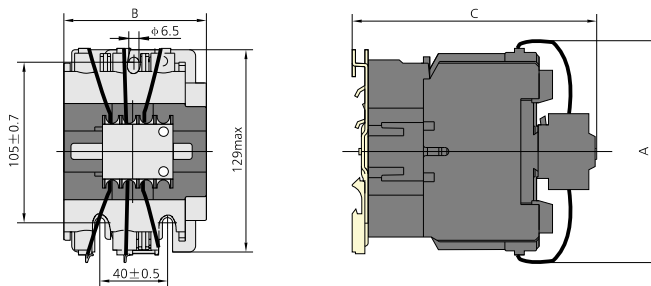

Model	Amax	Bmax	Cmax	Dmax	E	F	Note
CJ19-25	80	47	124	76	34/35	50/60	Screw mount/ 35mm rail mount
CJ19-32	90	58	132	86	40	48	
CJ19-43	90	58	136	86	40	48	
CJ19-63	132	79	150				
CJ19-95	135	87	158				

## 6. Wing and Installation

6.1 The connection terminals are protected through insulation cover, which is reliable and secure for installation and operation;

6.2 For CJ19-25~43, screws are available for installation, as well as the DIN rail; for CJ19-63~95, 35mm or 75mm standard rail are available for installation.